



Zürich, 21.10 2021

Analysis and recommendations

for the Feng Shui consultation for the conversion of the office premises
of the company:

XXXXXXX
XXXXXXXXXX, CH-XXXX XXXXXXXXX

by Michal Ricar

Table of content	Page
- Scope of work of the Feng Shui consultation	2
- Objectives and expectations of XXXXXX in order of priority	3
- Analysis of the location and the extended surroundings	4
- Analysis of the building	4
- Energy distribution inside the offices	5
- Suggested corrections	7
- Summary, brief reference to the recommended corrections	12
- Referenz floor-plan	14
- Reference Pi-Chart graphic	15

Scope of work of the Feng Shui consultation

- Analysis of the external environment and the location of the house and, if necessary and applicable, recommendations for optimisation.
- Analysis of the building and the company spaces .
- Ensuring the harmonious flow of energy inside the spaces.
- Ensuring that positive energy enter and remains in the XXXXX spaces.
- Analysis and recommendations of which cures in the working space would be beneficial to the XXXXX's goals.

Objectives and expectations of XXXXX XXX in order of priority

Maintain and possibly increase the success and growth of XXXXX (short, medium and long term, also after the reconstruction).

Maintaining and supporting the good working climate and optimising the employees' workplaces in the respective work areas.

Optimisation of the room structure according to Feng Shui guidelines.

Ensuring the harmonious distribution and to ensure a balance between movement- and resting- energies.

Analysis of the location and the extended surroundings

The office building is located in the industrial area of Spreitenbach.

It is situated at the end of a chain of hills which form the foothills of the Pre-Alps and the Alps behind.

Opposite this we find a wide and open area, which is bordered by railway tracks, the river Limmat and the motorway.

Adjacent to this is a formation of medium sized, harmoniously wavy hills.

This macro - situation can be considered very favourable.

Analysis of the building

The office building itself experiences a "polarity jump" from a Feng Shui point of view due to the construction of a hotel in close proximity.

What was in the front becomes in the back and vice versa.

This helps the building to integrate into the macro - situation of the landscape and is also positive.

In the situation after the construction of the hotel, which is then located behind the office building, we find further industrial buildings to the left and right, which offer additional protection.

To describe it figuratively, an "arm-chair situation" (backrest, armrests, free space in front) this constellation is also present.

We enter the building from the front through a bright and large glass door that leads directly to two large elevators, which in turn ensure good energy distribution inside the building.

Energy distribution inside the offices of the most relevant areas

(I limit myself here to the prominent zones that are most conducive to the objective. For reasons of practicability, weaker zones are formally corrected by placing furniture in consultation with the architect).

In the pie-chart like graphic (Page 15), we find the **West - Area** on the top left. In this area, the potential for activities that have to do with action, tackling, speed, productivity, etc., is extraordinarily favourable. But to make good use of this potential, the area should be designed to be airy, bright and not crowded.

Following the rule "nourish the roots", it is recommended that this zone be used by people in leading positions.

Managing director and deputy, chief financial officer, chief communication and marketing officer.

The West is generally considered supportive for sales and communication.

At the top right is the **North - Area**.

In this area, the potential for activities related to strategies, visions, determining the path, collecting energy and quiet activities is very good.

Therefore, this area is very auspicious for board members and CEOs.

The North also generally represents career and business development.

Middle - Area

This area is important for all employees. It is favourable for gaining and passing on knowledge and information (on the fly) as well as for social contacts.

Active as well as passive activities are supported.

This area should receive enough light, be inviting for a short stay, but remain very airy and open.

The centre stands for cohesion, health, business climate and for the company itself.

South West - Area

Here it is similar to the centre in terms of supported activities.

Favourable for acquiring and passing on knowledge and information, social contacts. Both active and passive activities are supported.

As a special feature in 2021/2022 it should be mentioned that there is a weak energy for employees who have their workplace in this area and spend most of their time there (e.g. however, it is well suited for the work desk of a field staff member)

This area would also be very suitable as a meeting room.

East area

Well suited as storage or possibly as an exhibition area for goods.

As a permanent workplace, this place is only recommended as a second choice.

South East - Area

This is the entrance area and a very important place in Feng Shui teachings.

It therefore needs a lot of attention and care.

The basic energy of the South East stands for prosperity.

However, in our case, it is not optimally supported by the flow and distribution of energy.

Here we should implement some corrections as described below.

Suggested corrections in recommended order of priority

Notes:

- *All corrections are implemented by the architect (therefore she will be instructed) and me.*
- *Please find the places where the corresponding corrections are to be applied on the floor-plan under the corresponding numbers (# or * 1 - 8)*
- *It was agreed with the management of XXXXX to place the employees with their corresponding activities in the proposed and prosperous places. It is also to be taken into account that the orientation of the desks of the four management staff will be adjusted to their energetically advantageous directions. The locations and working directions of Roland, Matthias, Patric and Kristina can be found in the reference graphic following the summary / brief reference.*

Suggested corrections in recommended order of priority

#1

Because it is not possible to determine exactly when the work will be carried out or when the objects and furniture will be delivered, we determine a symbolic start of the renovation on a date that is optimal from an energetic point of view.

Correction

Please tape off the lower a side wall in the centre area, with a painter's tape as a symbolic start of construction (as this can only be set for approximately the last week of Nov).

Thus we use a favourable date according to Feng Shui rules.

Time of correction

Friday, 12 November 2021 at 10H, 14h, 16H or 18H

Thursday, 18 November 2021 at 10H, 14h, 16H or 18H

2&3

We leave the lift on the sixth floor.

Straight ahead we look directly at the glass façade of the stair-lift area, which is located directly above the building entrance.

We need to ensure that the energy remains on the floor

Furthermore, two very large, diagonally running and gray coloured support columns are visible, which support the statics of the staircase. However, we want our view to fall first on a positive object that integrates harmoniously into the bright and elegant interior. To enter the offices entrance with a positive and pleasant feeling.

Correction

An eye-catcher should be installed approximately in the middle of the floor level to catch the visitor's attention and prevent it from wandering out of the house into the distance.

We want to keep the visitor's attention inside and, if possible, direct it to the XXXXX entrance. Likewise, this object is meant to distract from the supporting columns, which do not quite fit into the harmonious overall picture.

A good example is the mannequin group on a lower floor of the building.

#4

To the left of the lift are the XXXXX offices.

The entrance to the offices seems small, dark and oppressed in relation to the large, bright space of the floor level. Upon entering the level, we would like to direct the visitor's focus to the entrance of XXXXX.

The energy should be directed to the offices in a direct way.

Correction

The entrance to the office space should be brightly lit.

If possible with bright daylight - bulbs.

The entrance should also be attractively designed, thus defining the second fixed point after the eye-catcher in the middle. At the same time, we describe where the visitor's attention or energy is directed.

As a corrective for the weak energy distribution in the south-east, it is recommended to use round or cylindrical shapes, metallic surfaces and plants.

As an example: Place two cylindrical, metal-coloured plant pots or cylindrical glass vases with water, including plants (e.g. round cut boxwoods, to the left and right of the entrance.

#5

We enter a short, about 2.5m, narrow and rather dark corridor which leads to the offices.

The entrance to the large room is directly opposite the glass door of the emergency exit, which is located at the other end of the offices.

Here too, similar to the floor area, we find an we find potential to maintain good energy.

The energy loss caused by the opposite emergency exit is favoured by the uninterrupted, long distance between the entrance and the emergency exit.

The energy can escapes in a straight line instead of being distributed to the workplaces on the left and right.

Correction

The darkish entrance to the offices should also be made bright and attractive.

It would be advantageous to have a design element that incorporates space and movement, e.g. flat screens with sailing regatta footage or flight footage over water landscapes etc.

Whenever possible, the fire door should be left open to draw attention and energy inside the office.

#6

The effect mentioned in #4 is underlined, accelerated and channelled by the ceiling hanging down in this area, which acts as a link between the entrance and the emergency exit.

Correction

Here it is recommended to create a situation between the entrance and the emergency exit which slows down this strong, accelerated and channelled energy flow and allows it to spread out to the left and right to the workplaces.

For this purpose, it is advisable to configure this long straight path with objects in such a way that one has to meander. Objects around the centre can be used as the main visual accent. But in the middle, please keep it very airy and sparse.

Summary, brief reference to the recommended corrections in order of priority

#1 Symbolic start of the renovation

Please tape off the lower a side wall in the centre area, with a painter's tape as a symbolic start of construction (as this can only be set for approximately the last week of Nov).

Thus we use a favourable date according to Feng Shui rules.

Time of correction

Friday, 12 November 2021 at 10H, 14h, 16H or 18H

Thursday, 18 November 2021 at 10H, 14h, 16H or 18H

2&3 Ensure that the energy remains on the floor & redirect the energy to the entrance

An eye-catcher should be installed approximately in the middle of the floor level to catch the visitor's attention and prevent it from wandering out of the house into the distance.

We want to keep the visitor's attention inside and, if possible, direct it to the XXXXX entrance. Likewise, this object is meant to distract from the supporting columns, which do not quite fit into the harmonious overall picture.

A good example is the mannequin group on a lower floor of the building.

#4 Inviting the visitor's focus to the entrance of XXXXX

The entrance to the office space should be brightly lit.

If possible with bright daylight - bulbs.

The entrance should also be attractively designed, thus defining the second fixed point after the eye-catcher in the middle. At the same time, we describe where the visitor's attention or energy is directed.

As a corrective for the non-optimal energy distribution in the south-east, it is recommended to use round or cylindrical shapes, metallic surfaces and plants.

As an example: Place two cylindrical, metal-coloured plant pots or cylindrical glass vases with water, including plants (e.g. round cut boxwoods, to the left and right of the entrance).

#5 Attractive entrance

The darkish entrance to the offices should also be made bright and attractive.

It would be advantageous to have a design element that incorporates space and movement, e.g. flat screens with sailing regatta footage or flight footage over water landscapes etc.

Whenever possible, the fire door should be left open to draw attention and energy inside the office.

#6 Interrupting the straight line between the entrance and the emergency exit

Here it is recommended to create a situation between the entrance and the emergency exit which slows down this strong, accelerated and channelled energy flow and allows it to spread out to the left and right to the workplaces.

For this purpose, it is advisable to configure this long straight path with objects in such a way that one has to meander. Objects around the centre can be used as the main visual accent. But in the middle, please keep it very airy and sparse.

Referenz floor-plan

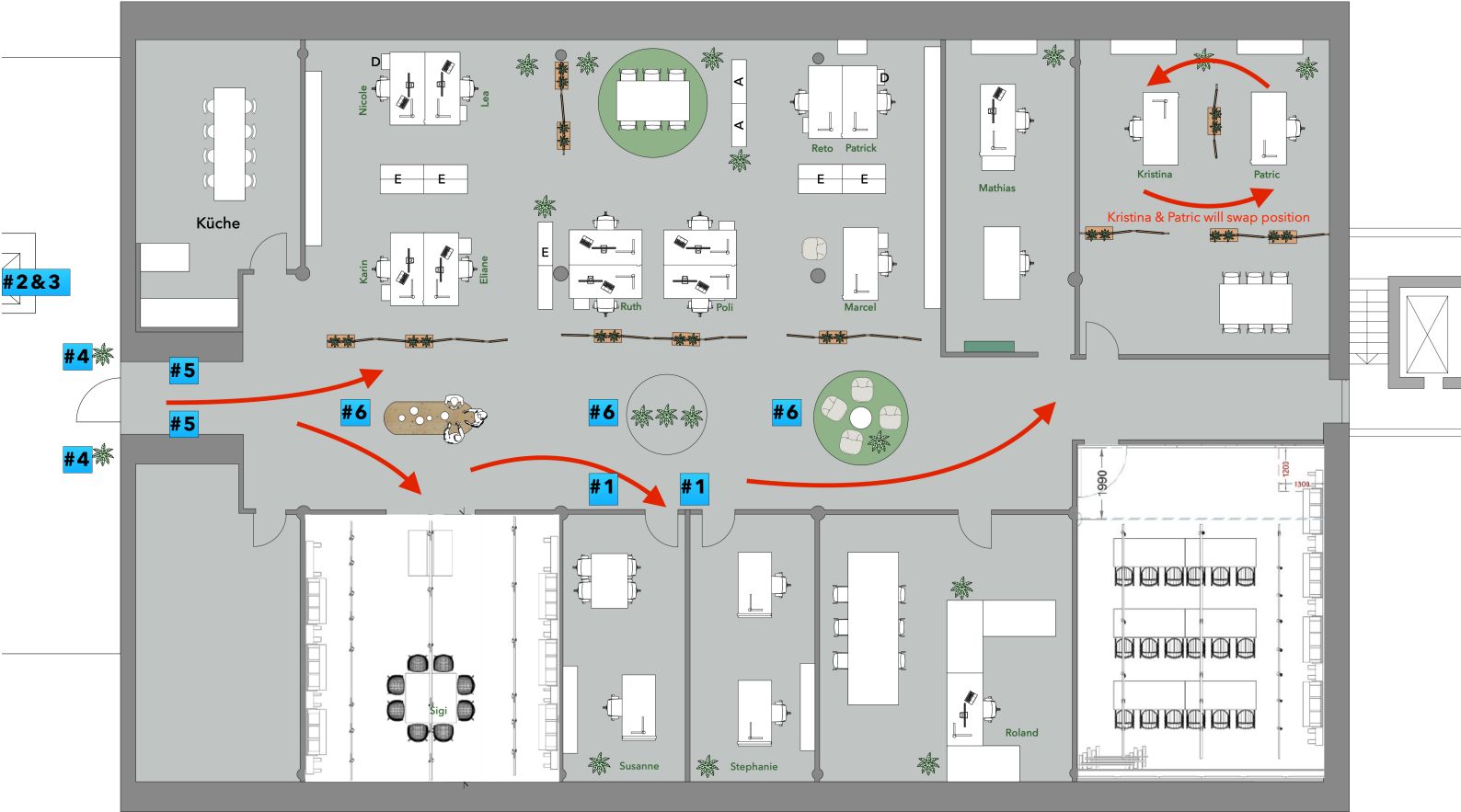

Reference Pi-Chart graphic

